



CLIMB ON

WHEEL LIFT BAR INSTALLATION

READ THESE INSTALLATION INSTRUCTIONS COMPLETELY BEFORE YOU START. IF YOU DON'T UNDERSTAND THESE INSTRUCTIONS, PLEASE CALL 800-453-1192 FOR ASSISTANCE

Procedure for replacing the Wheel Lift bar on Little Giant Ladder Systems **Adjustable Safety CAGE** and **6'-10' Compact Safety CAGE**.

1. Failure to comply with all instructions may result in serious injury.
2. Make sure this kit is compatible with your CAGE. Before installing this kit, identify all kit components. If any components are missing, damaged or if you have any questions concerning the use of this kit on Little Giant Ladder Systems products, please contact our Customer Experience Team at 800-453-1192. Do not substitute any components.
3. Inspect the CAGE before installing this kit. Repair or replace any damaged or missing CAGE parts before using the ladder. Use only Little Giant Ladder Systems repair or replacement parts. If you are unable to repair it, discard the CAGE.

COMPONENTS IN KIT

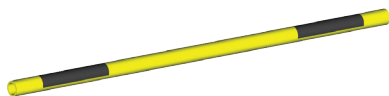

(1) YELLOW WHEEL
LIFT BAR w/ LABELS



(1) THREADED BAR
w/ (2) LOCK NUTS

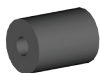

(2) SPACERS



(2) LOCK NUTS



(2) CAP NUTS

TOOLS NEEDED

7/16" WRENCH



LOCKING PLIERS

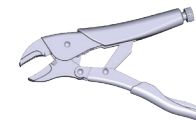

NOTE: IF ANY OTHER PART OF THE CAGE IS DAMAGED BEFORE OR DURING THE PROCESS OF INSTALLING AND/OR REPAIRING, PLEASE CONTACT OUR CUSTOMER EXPERIENCE TEAM FOR ASSISTANCE AT 800-453-1192. **DO NOT USE A DAMAGED CAGE!**

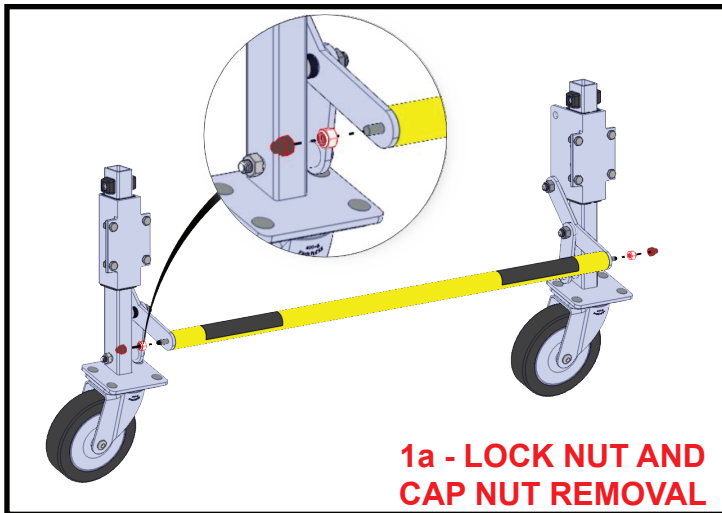

1a - LOCK NUT AND CAP NUT REMOVAL

1a. Identify the Wheel Lift bar that needs to be replaced. Remove and discard the cap nuts and lock nuts from both ends using a 7/16" wrench and locking pliers. Then, remove and discard the old yellow bar assembly.

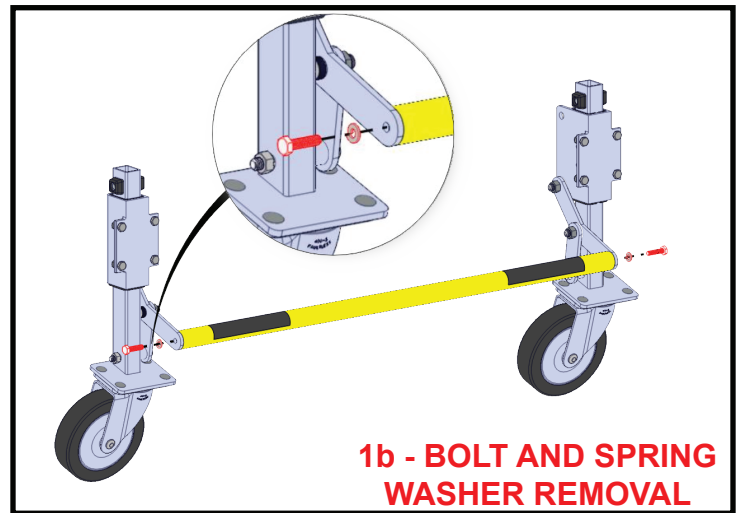

1b - BOLT AND SPRING WASHER REMOVAL

1b. Identify the Wheel Lift bar that needs to be replaced. Remove and discard the bolts and spring washers from both ends using a 7/16" wrench. Then, remove and discard the old yellow bar assembly.

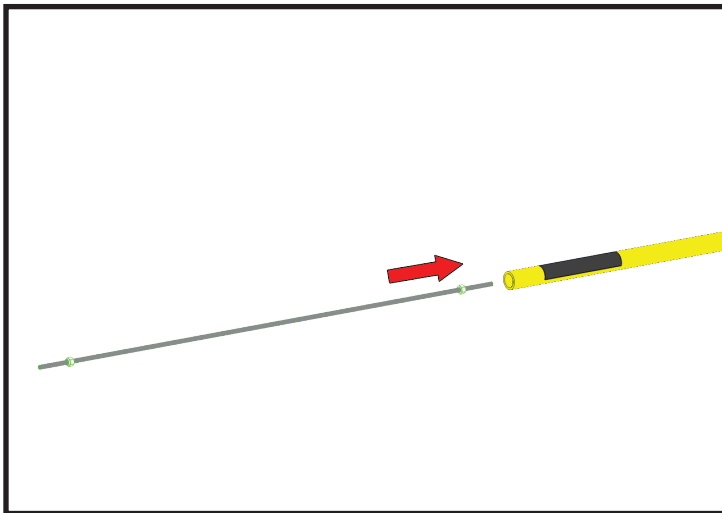

2. Insert the new threaded rod with the two lock nuts on it into the new yellow Wheel Lift bar.

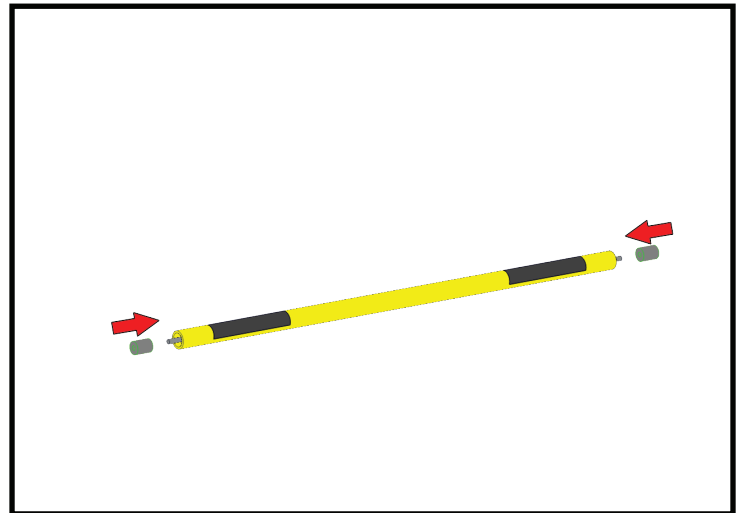

3. Insert the new spacers into each end of the yellow bar and onto the threaded rod.

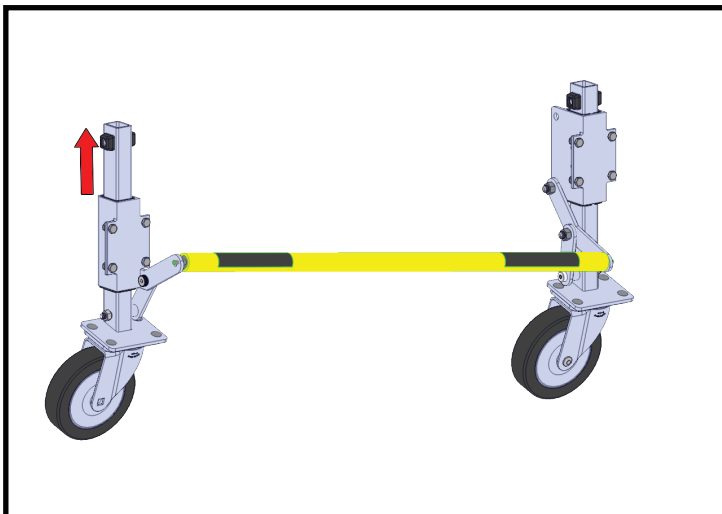

4. Place the new yellow bar assembly with the ends of the threaded rod through the holes in the arms of each wheel assembly. This is easiest when you retract one wheel assembly.

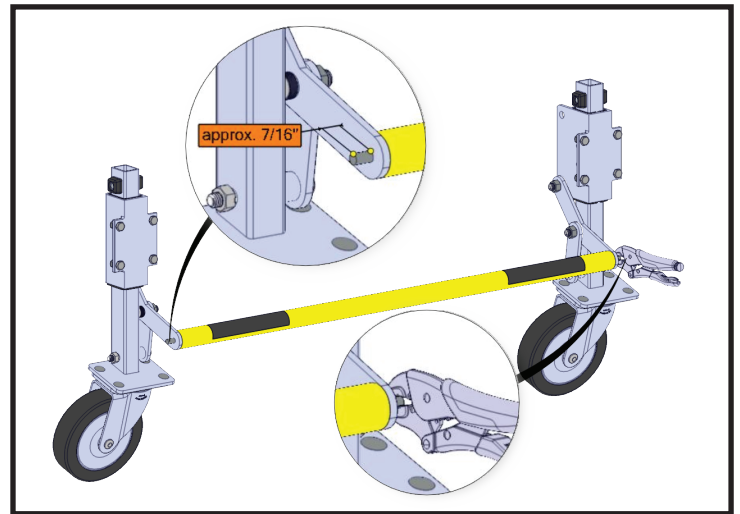

5. Center the threaded rod, where approximately 7/16" sticks out each side, then hold one end of the threaded rod in place with a pair of locking pliers.

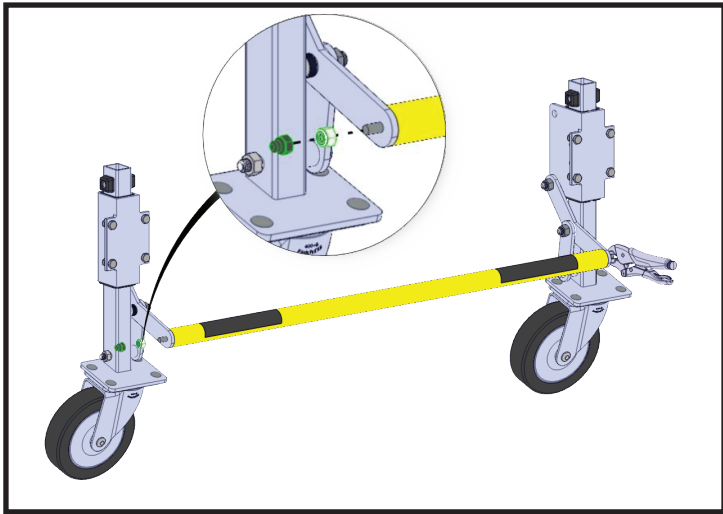

6. While holding the locking pliers, and making sure the labels are facing upward, install a new lock nut, using a 7/16" wrench, then install a new cap nut onto the exposed end of the threaded rod.

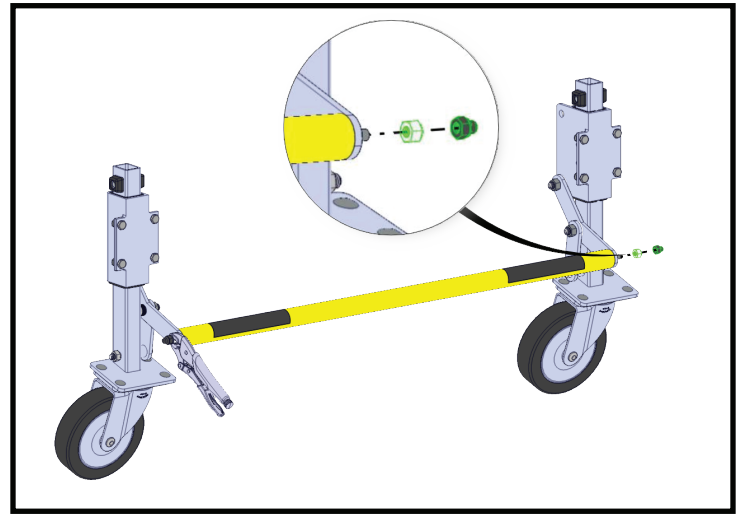

7. Move the locking pliers to the other side, and install the remaining lock nut and cap nut using a 7/16" wrench. Make sure the bar is completely tight and secure before returning the Wheel Lift to service.